

INSTRUCTION FOR CONECTING TO SD35-SECURED-STUDENTS PERSONAL WINDOWS 10 LAPTOP (Page 1)

1

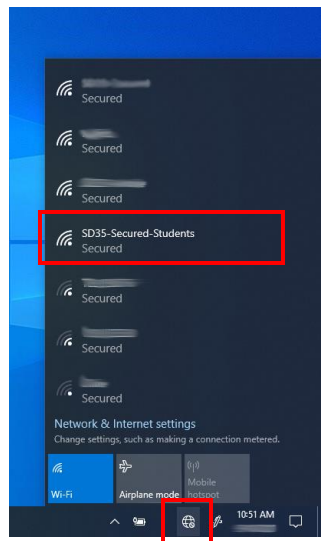

Click on Globe icon, then select "SD35-Secured-Students"

2

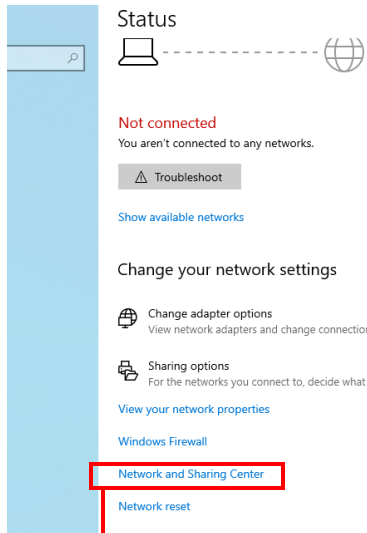

Click "Network and Sharing Center"

3

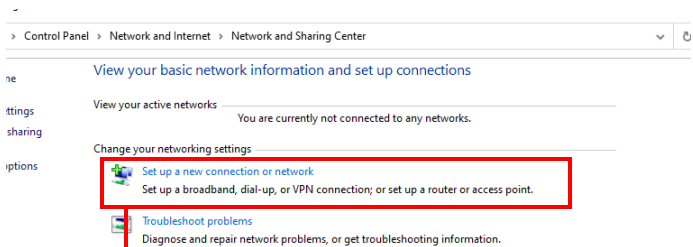

Click "Set up a new connection or network"

4

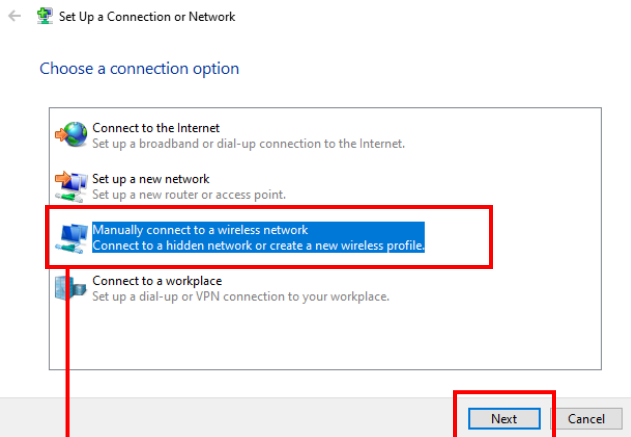

Select "Manually connect to a wireless network" and click Next

4

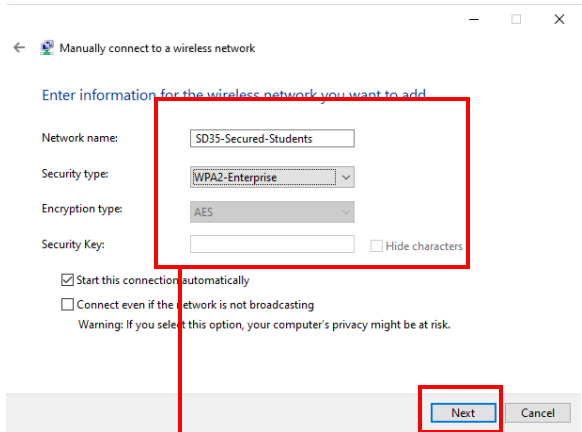

Fill in the required information as above, then click "Next"

6

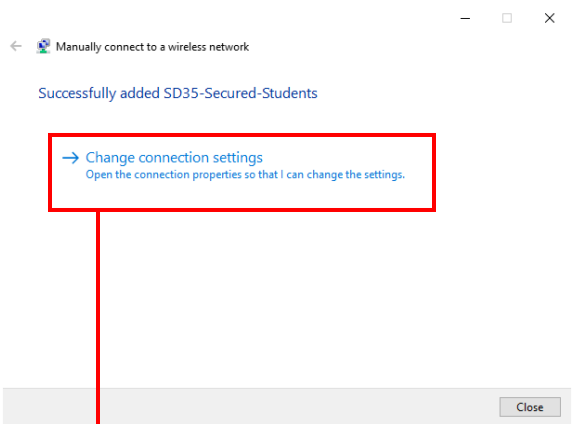

Click "Change connection Settings"

7

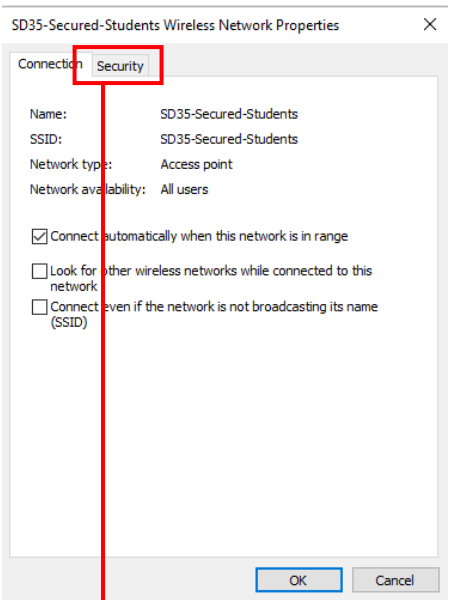

Click Security

8

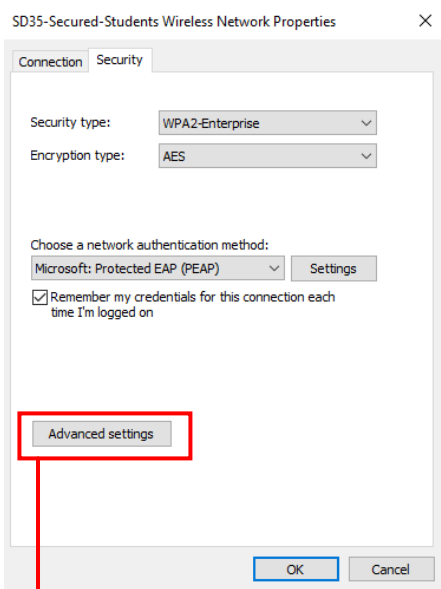

Click Advanced Settings

9

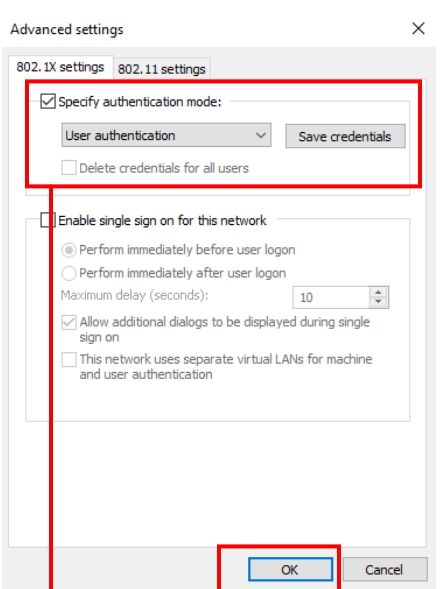

Ensure "User Authentication" is selected, then click "OK". Proceed to page 2

INSTRUCTION FOR CONECTING TO SD35-SECURED-STUDENTS PERSONAL WINDOWS 10 LAPTOP (Page 2)

10

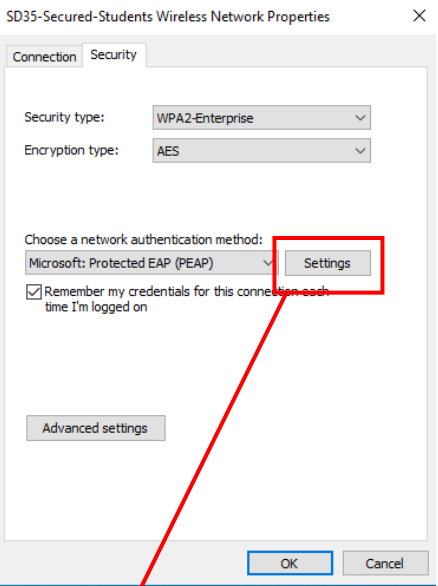

Click "Settings"

11

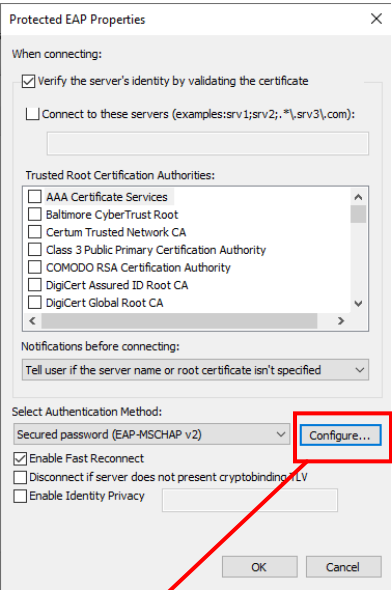

Click
"Configure"

12

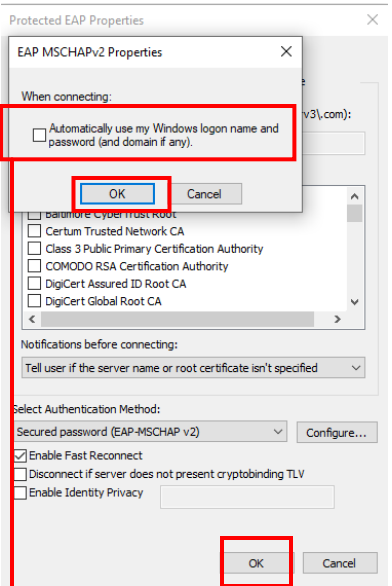

Uncheck the box
as shown, then
click OK

Click OK after finishing
the check box

13

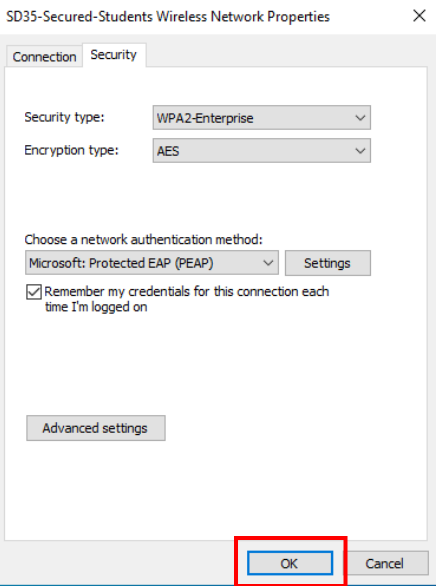

Click OK

14

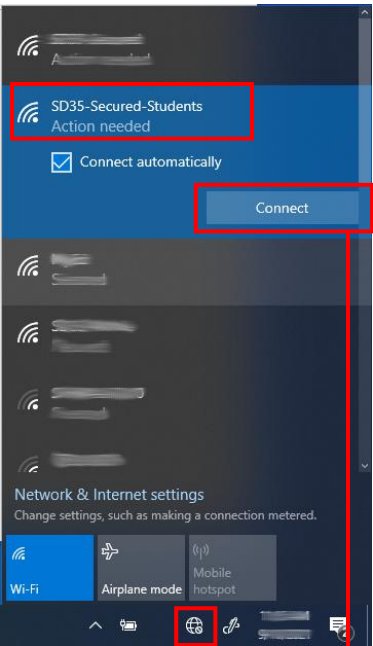

Click on the Globe,
Select SD35-Secured-
Students and Click
"Connect"

15

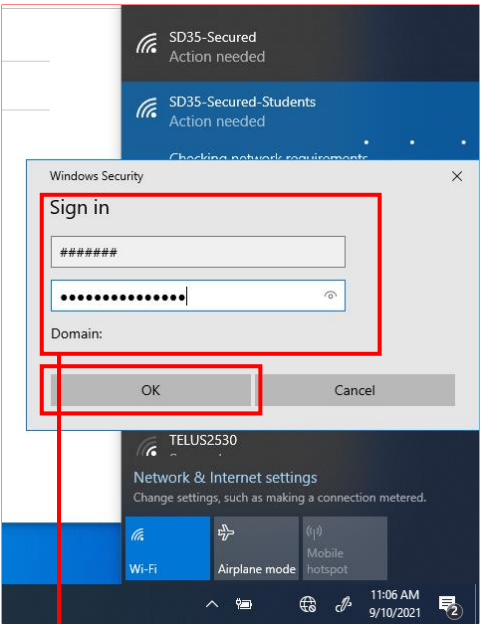

Enter your StudentID and
associate password, click
"OK"

16

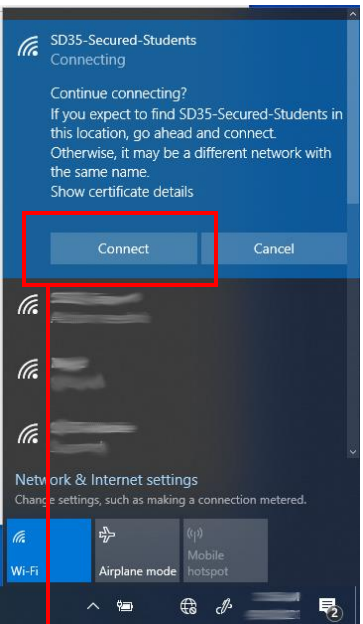

Click "Connect"

17

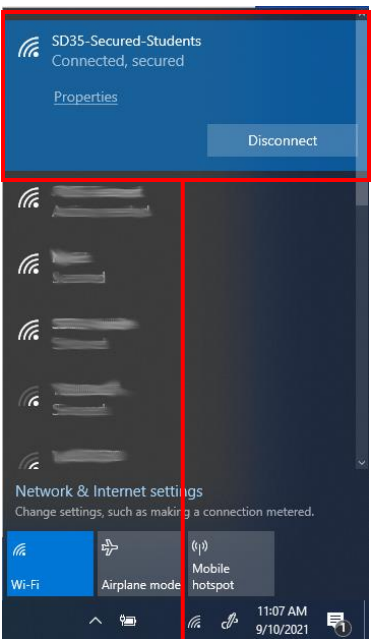

If everything is correct,
you should be
connected